



Installation regulations

Brink Air Control
English



Air for Life

Contents

1 User manual.	3	9 Environment.	22
1.1 Description Brink Air Control.	3	10 Troubleshooting and quarantine.	23
1.2 Symbols used.	3	10.1 Troubleshooting.	23
2 Technical specification.	4	10.2 Quarantee.	23
2.1 General product specification.	4	11 Appendix 1: Standard settings weekly programmes.	24
2.2 Environment influences.	4	11.1 Standard programme P1.	24
2.3 Overview operational controls.	4	11.2 Standard programme P2.	25
2.4 Overview display version main screen.	4	11.3 Standard programme P3.	26
2.5 Ventilation modes.	4	11 Appendix 2 Images.	27
3 Precautionary measures and safety instructions.	5	11.1 Image overview operational control.	27
3.1 General.	5	11.2 Image overview display.	27
3.2 During placement.	5	11.3 Image ventilation modes.	28
3.3 During use.	6	11.4 Image disconnecting operational module.	28
3.4 During maintenance.	6	11.5 Image electrical connection.	28
3.5 For the environment.	6	11.6 Image wall bracket.	29
4 Assembly and installation (to be performed by the installer).	7	11.7 Image replacing operational module.	29
4.1 Assembly.	7	11.8 Image filter notification.	30
4.1.1 Disconnecting the operational module from the wall bracket.	7	11.9 Image main menu display.	30
4.1.2 Mounting the wall bracket.	7	11.10 Image resetting filter.	31
4.1.3 Electrical connection.	7	11.11 Image device information menu.	32
4.1.4 Replacing the operational module in the wall bracket.	8	11.12 Image basic settings.	33
4.2 Installation.	8	11.13 Image installer menu.	34
4.2.1 Setting language.	8		
4.2.2 Setting time.	9		
4.2.3 Setting date.	9		
4.2.4 Selecting a device connected to the Brink Air Control	10		
5 Description of operation; manner of use.	11		
5.1 Navigation: general description.	11		
5.2 Selecting a device connected to the Brink Air Control	11		
5.3 Weekly programmes P1, P2 and P3.	11		
5.3.1 Standard settings P1, P2 and P3.	11		
5.3.2 Creating a P1 programme.	12		
5.3.3 Creating a P2 programme.	13		
5.3.4 Creating a P3 programme.	14		
5.4 Activating programme type (P1, P2 or P3).	16		
5.5 Temporarily overriding programme.	16		
5.6 Overriding programme for a longer period of time	16		
5.7 Setting ventilation mode values.	17		
5.8 Retrieving settings.	18		
5.9 Factory setting connected device.	18		
6 Maintenance.	19		
6.1 General maintenance.	19		
6.2 Cleaning or replacing filter.	19		
6.2.1 Filter notification.	19		
6.2.2 Removing, cleaning or replacing.	19		
6.2.3 Re-setting filter notification.	19		
7 Dismanteling.	20		
8 Repair.	21		

1 User manual

Dear client,

Thank you for buying the Brink Air Control. This user's manual contains all required information to quickly become familiar with the product. We kindly request you to carefully go through this information before using the product.

This user's manual is intended for the Brink Air Control installer and end user. You can retrieve the required information from the user's manual via the table of contents.

This is an extended user's manual. A Quick Start Guide is available, in addition to this user's manual.

Take good care of this user's manual!

For more information or ordering manuals, please contact:

Brink Climate Systems B.V.
Mailbox 11
NL-7950 AA, Staphorst, The Netherlands
T: +31 (0) 522 46 99 44
F: +31 (0) 522 46 94 00
E: info@brinkclimatesystems.com
www.brinkclimatesystems.com

1.1 Description Brink Air Control

Intended and unintended use

The Brink Air Control should be used in combination with products that have been approved by Brink Climate Systems B.V..

Brink Climate Systems B.V. cannot be held responsible for possible damage caused by improper, incorrect or unwise use. It is important that one understands this user's manual completely.

Working with other devices

The Brink Air Control is connected to other devices. The HRU (Heat Recovery Unit) is co-dependent on these devices' operation for its proper functioning. These devices' presence and proper functioning are prerequisites for using the Brink Air Control.

1.2 Symbols used



Warning!

The user can (seriously) injure himself or seriously damage the product.

A warning is indicative of a risk of damage to the user or product, if the user does not execute the procedures carefully.



Careful!

The product can be endangered. "Careful" is indicative of a risk of damage to the product, if the user does not execute the procedures carefully.



Take note!

A remark with supplementary information for the user. A remark draws the user's attention to possible problems.

2 Technical specification

2.1 General product specification

Product description

Name:	Brink Air Control
Model/ Type:	Brink Climate Systems B.V.

Technical product specifications

Electricity:	15 to 24 Volt
Power consumption:	1,5 Watt
Protection class:	IP30
Power reserve:	> 48 hours

Ambient conditions

Ambient temperature:	0 °C to 50 °C
Storage temperature:	-20 °C to 60 °C
Humidity:	10% to 90%
Other:	Exclusively for indoor use

2.2 Environment influences

The Brink Air Control should be placed and used in a space with the correct ambient conditions for proper operation. The Brink Air Control may only be mounted on the indoors, but not on the vicinity of a heat source, a radiator, in a draft or in a humid environment. The Brink Air Control may also not be exposed to direct radiation heat (sun light). The Brink Air Control may also not be mounted in the vicinity of a magnetic field. This could damage internal components.

2.3 Overview operational controls

The Brink Air Control has a number of buttons with which the device can be operated: (→ [Image overview operational control](#) page 27)

2.4 Overview display version main screen

(→ [Image overview display](#) page 27)

2.5 Ventilation modes

The Brink Air Control has four ventilation modes (→ [Image ventilation modes](#) page 28). You can activate a ventilation mode yourself (for more information see → [Description of operation; manner of use](#) page 11). You can adjust every ventilation mode yourself (for more information → [Setting ventilation mode values](#) page 17). You can retrieve the set values at the Device information menu (see → [Image basic settings](#) page 33 and → [Retrieving settings](#) page 18).

3 Precautionary measures and safety instructions

3.1 General



Warning!

The installation and assembly activities required to commission your Brink Air Control should be performed by an installer approved by Brink Climate Systems B.V..



Warning!

Immediately remove the power from your Brink Air Control by removing the connected device's plug from the socket, if:

- Parts of the Brink Air Control lie open, are pierced or had fallen hard;
- The power cable is damaged;
- The screen is cracked or broken.

Then contact Brink Climate Systems B.V. or your supplier.



Take note!

Never use parts other than original parts.



Take note!

Only use the Brink Air Control indoors, at temperatures between 0 °C and 50 °C and with a relative humidity between 10% and 90%.



Take note!

All settings (excluding the filter message) will be lost if the Brink Air Control breaks down or if the factory settings are reset. There is no backup available.

3.2 During placement



Take note!

Assembly and installation should be performed by an installer approved by Brink Climate Systems B.V.. The following requirements should be taken into account during placement:

- The Brink Air Control should be placed at a height of approximately 1.65 meters above the floor;
- The Brink Air Control may not be covered, for example, by a curtain or a cabinet;
- Consult paragraph → [Environment influences](#) page 4 for environmental requirements.

3.3 During use



Take note!

Settings, which have not been described in this user's manual, are intended for installers approved by Brink Climate Systems B.V.. Do not change these by yourself.

3.4 During maintenance



Careful!

Clean the screen with a soft cloth.



Careful!

Never apply water and/or (cleaning) liquid to the screen.

3.5 For the environment



Take note!

The Brink Air Control may not be removed as unsorted urban waste, but should be treated separately.



Take note!

Make enquiries within your own region, where the Brink Air Control can be handed in when use has been terminated. Do not throw away electrical devices or parts, but check if (parts of) the Brink Air Control cannot be handed in, recycled or re-used.

4 Assembly and installation (to be performed by the installer)

Assembly and installation should be performed by an installer approved by Brink Climate Systems B.V..

4.1 Assembly

You should perform the steps, described in paragraph (→ [Disconnecting the operational module from the wall bracket](#) page 7) through paragraph (→ [Replacing the operational module in the wall bracket](#) page 8), one by one, to assemble the Brink Air Control.

4.1.1 Disconnecting the operational module from the wall bracket

Disconnect the operational module from the wall bracket. Perform the following actions (→ [Image disconnecting operational module](#) page 28):

- Slide the control unit upward over the two guide profiles of the wall bracket until the control unit can be taken off.

4.1.2 Mounting the wall bracket

The wall bracket can be attached to a wall box (Ø 55 mm) or can be directly mounted on the wall with screws and plugs.

- Screw the wall bracket onto the wall in the correct position. Here one must use the mounting holes in the wall bracket (→ [Image wall bracket](#) page 29).



Take note!

Consult (→ [During placement](#) page 5) for more information on placing the Brink Air Control.

4.1.3 Electrical connection

The following actions should be performed to connect the Brink Air Control electrically (→ [Image electrical connection](#) page 28):

- Feed the two-core wire (from the device to be connected) through via opening at the back of the wall bracket.
- Check that the cables' ends have been stripped in the correct manner. If this is not the case, do so.
- Screw the cable to the terminal No. 1 and No. 2. Consult the installation instructions of the device to be connected, for more information on the correct connection.

4.1.4 Replacing the operational module in the wall bracket

Place the operational in the wall bracket mounted on the wall. Perform the following actions for this (→ [Image replacing operational module](#) page 29):

- Slide the control unit downward over the two guide profiles. Make sure the guide profiles of the wall bracket fit snugly.



Take note!

The operational module should click onto the wall bracket. Only then is a proper electrical connection established.

4.2 Installation

4.2.1 Setting language

You can set the language in which the menus are presented. Perform the following actions to set the language (see → [Image overview operational control](#) page 27 , → [Image overview display](#) page 27 & → [Image basic settings](#) page 33):

- Press returnkey "2" as many times as necessary to get to the main screen
- Press setting knob "1"; 'Main Menu' opens
- Select 'Basic Settings' by turning setting knob "1"
- Press setting knob "1"; 'Basic Settings' opens
- Select 'Language' by turning setting knob "1"
- Press setting knob "1"; 'Language' opens
- Select the desired language by turning setting knob "1"
- Press setting knob "1" to set the selected language
- Press returnkey "2" as many times as necessary to get to the main screen



Take note!

The names of the described menu items will not correspond with this user manual's menu items if the Brink Air Control is set to a language other than Dutch.

4.2.2 Setting time

You can set the time. The time is visible on the main screen. The Brink Air Control only has 24 hour representation. Perform the following actions to set the time (→ [Image overview operational control](#) page 27):

- Press returnkey "2" as many times as necessary to get to the main screen
- Press setting knob "1"; 'Main Menu' opens
- Select 'Basic Settings' by turning setting knob "1"
- Press setting knob "1"; 'Basic Settings' opens
- Select 'Clock' by turning setting knob "1"
- Press setting knob "1"; 'Clock' opens
- Change the time by turning setting knob "1"
- Press setting knob "1" to confirm the time
- Repeat the previous two steps for both the minutes and seconds
- Press returnkey "2" as many times as necessary to get to the main screen

4.2.3 Setting date

You can set the date. The date is visible on the main screen. Perform the following actions to set the date (see → [Image overview operational control](#) page 27 , → [Image main menu display](#) page 30 & → [Image basic settings](#) page 33):

- Press returnkey "2" as many times as necessary to get to the main screen
- Press setting knob "1"; 'Main Menu' opens
- Select 'Basic Settings' by turning setting knob "1"
- Press setting knob "1"; 'Basic Settings' opens
- Select 'Date' by turning setting knob "1"
- Press setting knob "1"; 'Date' opens
- Change the day by turning setting knob "1"
- Repeat the previous two steps for both the months and the year
- Press returnkey "2" as many times as necessary to get to the main screen

4.2.4 Selecting a device connected to the Brink Air Control

You can choose the device you want to regulate with the control if multiple devices are connected to Brink Air Control. Proceed as follows to set the appliance selection (see → [Image overview operational control](#) page 27 & → [Image installer menu](#) page 34):

- Press returnkey "2" as many times as necessary to get to the main screen
- Press setting knob "1"; 'Main Menu' opens
- Select 'Installer' by turning setting knob "1"
- Press setting knob "1"; 'Installer' opens
- Select 'Device' by turning setting knob "1"
- Press setting knob "1" to confirm selected device

If only one appliance is connected, no choice is offered and only Heat Recovery Unit appliance is displayed.

5 Description of operation; manner of use

You can increase or decrease the ventilation mode with the Brink Air Control. You can do this by setting a program. You can temporarily override the program while it is running.

5.1 Navigation: general description

Navigating through menus

The Brink Air Control has menus that you can navigate through. For this you use setting knob "1" (see → [Image overview operational control](#) page 27). You scroll through the menus by turning the setting knob "1" (→ [Image main menu display](#) page 30) You can open a selected menu-item by pressing the navigation button(→ [Image main menu display](#) page 30).

Return to the main screen

The main screen (→ [Image overview display](#) page 27) is the Brink Air Control start screen. You can always return to the main screen by pressing on the returnkey "2" (→ [Image overview operational control](#) page 27) a few times. The number of times you need to press return depends on how deep you have gone into the menu. U need not be afraid of pressing return too frequently.

5.2 Selecting a device connected to the Brink Air Control

You can choose the device you want to regulate with the control if multiple devices are connected to Brink Air Control (→ [Selecting a device connected to the Brink Air Control](#) page 10).

5.3 Weekly programmes P1, P2 and P3

You can programme the regulation of the ventilation mode in a weekly program. You can choose from programs P1, P2 and P3.

Program P1

With this you create a day program for every day of the week.

Program P2

With this you create two day programs.

One day program for weekdays 'mo-fri' and one day program for the weekend 'sa-su'.

Program P3

With this you create seven day programs.

Separately for every day of the week.

5.3.1 Standard settings P1, P2 and P3

The Brink Air Control has standard set weekly programmes. You can find these settings in appendix 1 (→ [Appendix 1: Standard settings weekly programmes](#) page 24).

5.3.2 Creating a P1 programme

→ [Image overview operational control](#) page 27

- Press returnkey "2" as many times as necessary to get to the main screen
- Press setting & activating time program knob "3"; 'Setting & activating timer programme' opens
- Select 'P1: week' by turning setting knob "1"
- Press setting knob "1"; 'P1: week' opens

You have a choice from 'Period 1', 'Period 2', 'Period 3', 'Period 4', 'Period 5' and 'Period 6'. Every period is a part of the day in which you can set a ventilation position.

Perform the following actions to set period 1:

- Select 'P1' by turning setting knob "1"
- Press setting knob "1"; 'Period 1' opens
- Select 'Start Time' by turning setting knob "1"
- Press setting knob "1"; 'Start Time' opens
- Change the start time by turning setting knob "1"
- You have a range of between 3.00u and 2.59u



If in a period the time is turned back so far that lines appear, that period and the one above it will be deleted.

- Press setting knob "1" to confirm the start time

Now set the ventilation mode for period 1. Perform the following actions for this:

- Select 'Ventilatiestand' by turning "1"
- Press "1", 'Ventilatiestand' opens
- Set the ventilation mode for period 1 by turning "1"
- Press "1" to confirm the ventilation mode for period 1

You have set the ventilation mode for period 1. You can set period 2 through 6 in the same manner. A period ends when a new one starts.

5.3.3 Creating a P2 programme

→ [Image overview operational control](#) page 27

- Press returnkey "2" as many times as necessary to get to the main screen
- Press setting & activating time program knob "3"; 'Setting & activating timer programme' opens
- Select 'P2: week/weekend' by turning setting knob "1"
- Press setting knob "1"; 'P1: week/weekend' opens

You can choose between 'Week' and 'Weekend'. With 'Week' you can set a day program for Monday through Friday. With 'Weekend' you can set a day program for Saturday and Sunday.

Week

- Select 'Week' by turning setting knob "1"
- Press setting knob "1"; 'Week' opens

[*] You have a choice from 'Period 1', 'Period 2', 'Period 3', 'Period 4', 'Period 5' and 'Period 6'. Every period is a part of the day in which you can set a ventilation mode.

Perform the following actions to set period 1:

- Select 'Period 1' by turning setting knob "1"
- Press setting knob "1"; 'Period 1' opens
- Select 'start time' by turning setting knob "1"
- Press setting knob "1"; 'start time' opens
- Change 'start time' by turning setting knob "1"; You have a range of between 3.00 hrs and 2.59 hrs
- Press setting knob "1" to confirm start time

Now set the ventilation mode for period 1.

Perform the following actions for this:

- Select 'Ventilatiestand' by turning setting knob "1"
- Press setting knob "1"; 'Ventilatiestand' opens
- Set the ventilation mode for period 1 by turning setting knob "1"
- Press setting knob "1" to confirm the airflow for period 1

You have set the ventilation mode for period 1 You can set period 2 through 6 in the same manner. A period ends when a new one starts.

- Follow the steps from paragraph 5.3.3, until you have a choice between 'Week' and 'Weekend'
- Select 'Weekend' by turning setting knob "1"
- Press setting knob "1"; 'Weekend' opens
- Continue the steps from paragraph 5.3.3 at (*)

5.3.4 Creating a P3 programme

→ [Image overview operational control](#) page 27

- Press returnkey "2" as many times as necessary to get to the main screen
- Press setting & activating time program knob "3"; 'Setting & activating timer programme' opens
- Select 'P3: day' by turning setting knob "1"
- Press setting knob "1"; 'P3: day' opens

(*) You can choose from the days between 'Monday' through 'Sunday'. You perform the following steps to set a day program for Monday:

- Select 'Monday' by turning setting knob "1"
- Press setting knob "1"; 'Monday' opens

You have a choice from 'Period 1', 'Period 2', 'Period 3', 'Period 4', 'Period 5' and 'Period 6'. Every period is a part of the day in which you can set a ventilation position.

- Select 'Period 1' by turning setting knob "1"
- Press setting knob "1"; 'Period 1' opens
- Select 'Start time' by turning setting knob "1"
- Press setting knob "1"; 'Start time' opens
- Change 'Start time' by turning setting knob "1"; You have a range of between 3.00u and 2.59u
- Press setting knob "1" to confirm 'Start time'

Now set the ventilation mode for period 1.
Perform the following actions for this:

- Select 'Ventilatiestand' by turning setting knob "1"

- Press setting knob "1"; 'Ventilatiestand' opens
- Set the ventilation mode for period 1 by turning setting knob "1"
- Press setting knob "1" to confirm the ventilation mode for period 1

You have set the ventilation mode for period 1 You can set period 2 through 6 in the same manner. A period ends when a new one starts.

If you have created a day program for Monday, you can do the same for the other days of the week. Then repeat the steps from paragraph 5.3.4, but, after (*) choose another day instead of 'Monday'.

5.4 Activating programma type (P1, P2 or P3)

The Brink Air Control has three types of weekly programs P1, P2 and P3. You can program the weekly programs by yourself, for more information see paragraph .→ [Weekly programmes P1, P2 and P3](#) page 11.

Perform the following actions if you wish to program one of the weekly programs (→ [Image overview operational control](#) page 27):

- Press returnkey "2" as many times as necessary to get to the main screen
- Press setting & activating time program knob "3"; 'Setting & activating timer programme' opens
- Select 'Active program' by turning setting knob "1"
- Press setting knob "1"; 'Active program' opens
- Select 'P1, P2 or P3' by turning setting knob "1"
- Press setting knob "1" to activate P1, P2 or P3

5.5 Temporarily overriding programme

You can temporarily override the program. You need to perform the following actions for this (→ [Image overview operational control](#) page 27):

- Press returnkey "2" as many times as necessary to get to the main screen.
- Press knob "5"; 'Bypassing the timer programme' opens.
- Turn setting knob "1" to temporarily set the ventilation mode.

Take note!



It is stated at the top of your screen, how long the newly set ventilation mode applies. The program will be enabled again after this period of time. The override period will be 30 minutes if you overruled the device in the maximum position. You can also undo this by pressing returnkey "2". Returnkey "2" can not be operated until some 10 seconds after the latest setting!

5.6 Overriding programme for a longer period of time

A set program me can be overridden manually, for example, during holidays. Perform the following actions to overrule the program (→ [Image overview operational control](#) page 27):

- Press returnkey "2" as many times as necessary to get to the main screen
- Press knob "4" and 'Manual' appears in the display
- Turn setting knob "1" to set the ventilation position

The manual position now overrules the programme. Press returnkey "2" if you wish to undo the manual position. Returnkey "2" can not be operated until some 10 seconds after the latest setting!

5.7 Setting ventilation mode values

You can set a ventilation mode's value by yourself.

Perform the following actions for this (see → [Image overview operational control](#) page 27 & → [Image installer menu](#) page 34):

- Press returnkey "2" as many times as necessary to get to the main screen
- Press setting knob "1"; 'Main Menu' opens
- Select 'Installer' by turning setting knob "1".
- Turn setting knob "1" to select the desired appliances
- Press setting knob "1" to confirm the desired appliance (or select the choice HRV appliance if only one appliance is connected).
- Select 'Device settings' by turning setting knob "1".
- Press setting knob "1"; 'Device settings' opens
- Select 'Airflow 0 (Holiday)' by turning setting knob "1"



Take note!

'Airflow 0 (Holiday)' refers to ventilation mode



'Airflow 1 (Reduced)' refers to ventilation mode



'Airflow 2 (Normal)' refers to ventilation mode



'Airflow 3 (High)' refers to ventilation mode



- Set Airflow 0 (Holiday) by turning setting knob "1".
- Press setting knob "1" to confirm the set value for Airflow 0 (Holiday)

You can set debit 1 through 3 in the same manner as described above for Airflow 0 (Holiday).



Take note!

You cannot feed in a value, lower than value of a lower Airflow position, for a higher (Airflow Holiday < Airflow Reduced < Airflow Normal < Airflow High).

5.8 Retrieving settings

You can retrieve the current settings from the Brink Air Control:

- Press returnkey "2" as many times as necessary to get to the main screen
- Press setting knob "1" 'Main Menu' opens
- Turn setting knob "1" to select the desired appliances
- Press setting knob "1" to confirm the desired appliance (or select the choice HRV appliance if only one appliance is connected).
- Select 'Device information' by turning setting knob "1" .
- Press setting knob "1"; 'Device information' opens
- Turn setting knob "1" to display the desired appliances



Take note!

You can look at, but not change, the settings via the info menu.

5.9 Factory setting connected device

A device has been connected to the Brink Air Control. It is possible to set back all this device's settings to the factory settings. Perform the following actions for this (→ [Image overview operational control](#) page 27):

- Press returnkey "2" as many times as necessary to get to the main screen
- Press setting knob "1" 'Main Menu' opens
- Select 'Installation Settings' by turning setting knob "1".
- Press setting knob "1"; 'Installation Settings' opens
- Select 'Installer' by turning setting knob "1".
- Press setting knob "1"; 'Installer' opens
- Select 'Factory Setting' by turning setting knob "1".
- Press setting knob "1"; 'Factory Setting' opens
- Turn setting knob "1" to select the option 'yes'
- Press setting knob "1" to confirm the desired 'Factory Setting' (or select the choice HRV appliance if only one appliance is connected).
- The settings are put back to the factory settings. Selecting factory setting will restore all step numbers to the original factory setting. All fault messages will be deleted as well.

6 Maintenance

6.1 General maintenance

**Careful!**

Clean the screen with a soft cloth.

**Careful!**

Never apply water and/or (cleaning) liquid to the screen.

6.2 Cleaning or replacing filter

6.2.1 Filter notification

The filters in the device, connected to the Brink Air Control, should be cleaned or replaced when the text 'FILTER' appears on the Brink Air Control display (→ [Image filter notification](#) page 30).

6.2.2 Removing, cleaning or replacing

Consult the manual of the device connected to the Brink Air Control for removing, cleaning and replacing filters.

6.2.3 Re-setting filter notification

You can reset the filter notification after you have cleaned or replaced the filter (or the filters). For this you press the setting knob "1" for at least five seconds (see → [Image overview operational control](#) page 27 & → [Image resetting filter](#) page 31).

Press returnkey "2" to get to the main screen.

The text filter on the Brink Air Control display disappears.

7 Dismanteling



Warning!

You are not permitted to dismantle the Brink Air Control or parts of the Brink Air Control by yourself. This may only be done by a maintenance mechanic approved by Brink Climate Systems B.V..

8 Repair



Warning!

You are not permitted to open or repair the Brink Air Control or parts of the Brink Air Control by yourself. This may only be done by a maintenance mechanic approved by Brink Climate Systems B.V..

9 Environment

**Take note!**

The Brink Air Control may not be removed as unsorted urban waste, but should be treated separately.

**Take note!**

Make enquiries within your own region, where the Brink Air Control can be handed in when use has been terminated. Do not throw away electrical devices or parts, but check if (parts of) the Brink Air Control cannot be handed in, recycled or re-used.

RoHS-compliance

This product meets Directive 2011/65/EU of the European Parliament and the Council of 27 January 2003 regarding using certain environmentally hazardous substances in electronic equipment (RoHS) and the amendments to the directive.

WEEE-notification

The WEEE-directive (Waste Electrical and Electronic Equipment), which came into force, as European law, on 13 February 2003, has resulted in an important change in treating electronic equipment at the end of their use cycle. This directive's objective is, firstly, preventing electronic equipment in waste and moreover promoting re-use, recycling and other forms of recovering such waste in order to limit the amount of waste.

The WEEE-logo on a product or on the packaging indicates that this product may not be disposed of or thrown away with domestic waste. You should dispose of all your old electronic or electrical equipment via special collection points for such dangerous waste. Separate collection and correct treatment of our old electronic and electrical equipment help us to maintain our natural resources.

Moreover, correct recycling guarantees the safety and health of humankind and the environment. For more information on processing electronic and electrical equipment, re-use and collection points, please contact you municipality, your local waste disposal company, the supplier from whom you purchased the device or the device's manufacturer.



WEEE logo

Handing in and recycling

Make enquiries within your own region, where the Brink Air Control can be handed in when use has been terminated. Do not throw away electrical devices or parts, but check if (parts of) the Brink Air Control cannot be handed in, recycled or re-used.

10 Troubleshooting and quarantine

10.1 Troubleshooting

See the installation instructions of the device connected to the Brink Air Control for troubleshooting for the error notifications indicated on the Brink Air Control.

10.2 Quarantee

The Brink Air Control has been manufactured by Brink Climate Systems B.V. with care and in accordance with high quality standards. The Brink Air Control operation is guaranteed for a period of twelve months from the time of delivery. This guarantee is granted in accordance with Brink Climate Systems B.V. General Terms and Conditions.

These can be found on www.brinkclimatesystems.com.

Do you want to claim under the guarantee?

You then have to make that known, in writing, via:

Brink Climate Systems B.V.

Mailbox 11

NL-7950 AA, Staphorst, The Netherlands

The right to guarantee lapses in case of incorrect or improper use of the Brink Air Control and failure to follow the user indications in this user's manual.



Warning!

Making changes to the Brink Air Control hardware or software is not permitted. This can have an effect on the Brink Air Control proper operation and in that case all guarantees lapse.





Warning!

You are not permitted to open or repair the Brink Air Control or parts of the Brink Air Control by yourself. In that case guarantees lapse.

11 Appendix 1: Standard settings weekly programmes

11.1 Standard programme P1

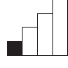
Week (Monday through Sunday)

Period	Start time	Ventilation mode
1	07.00	
2	08.00	
3	17.00	
4	22.00	
5	Not set	
6	Not set	

11.2 Standard programme P2

Week (Monday through Friday)

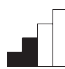
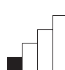
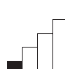
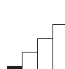
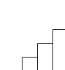

Period	Start time	Ventilation mode
1	07.00	
2	08.00	
3	17.00	
4	22.00	
5	Not set	
6	Not set	

Weekend (Saturday and Sunday)

Period	Start time	Ventilation mode
1	08.00	
2	23.00	
3	Not set	
4	Not set	
5	Not set	
6	Not set	

11.3 Standard programme P3

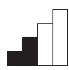
Monday

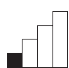
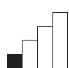
Period	Start time	Ventilation mode
1	07.00	
2	08.00	
3	17.00	
4	22.00	
5	Not set	
6	Not set	

Tuesday (the same as Monday)

Wednesday (the same as Monday)

Thursday (the same as Monday)

Friday (the same as Monday)

Saturday (the same as Monday)

Sunday (the same as Monday)

Appendix 2 Images

11.1 Image overview operational control

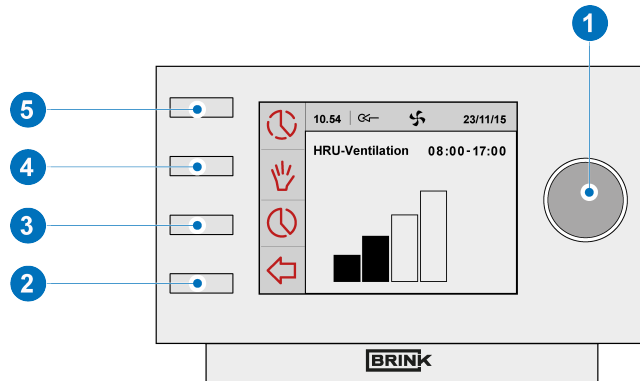



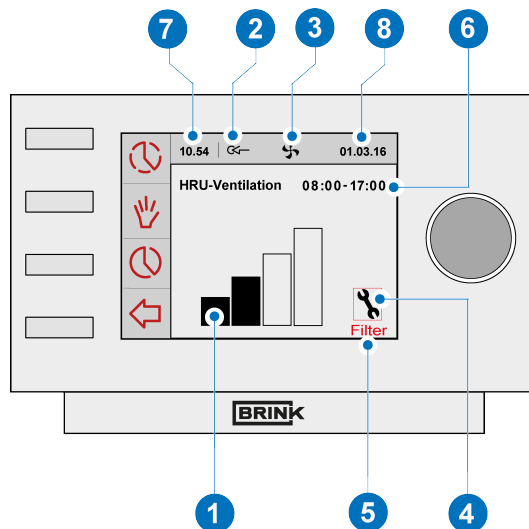

- 1 = Setting knob
- 2 = Return key
- 3 = Setting & activating timer programme
- 4 = Manual control key
- 5 = Bypassing the timer programme

11.2 Image overview display

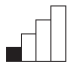

- 1 = Flow rate indicator
- 2 = eBus connection indicator
- 3 = Fan indicator
- 4 = Fault symbol
- 5 = Filter message
- 6 = Current time block
- 7 = Current time
- 8 = Current date (day/ month/ year)

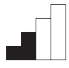
11.3 Image ventilation modes

	
	1
	2
	3

11.4 Image disconnecting operational module

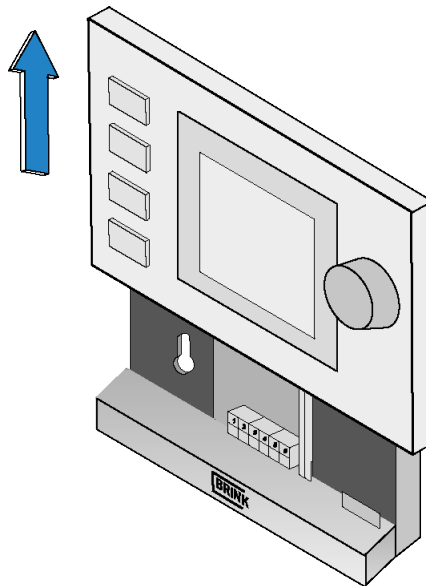

11.5 Image electrical connection

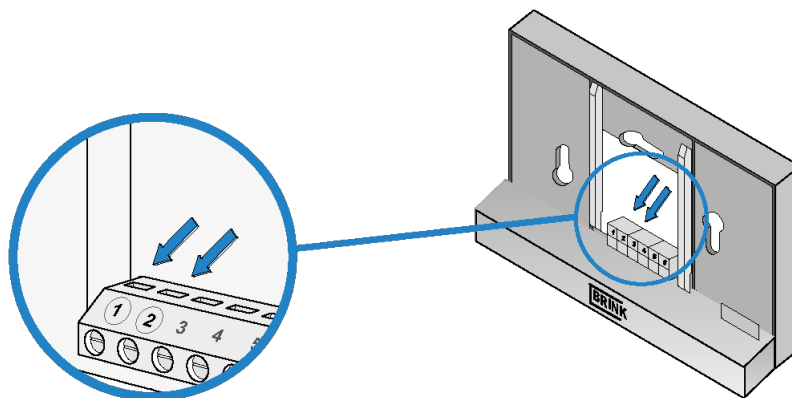

11.6 Image wall bracket

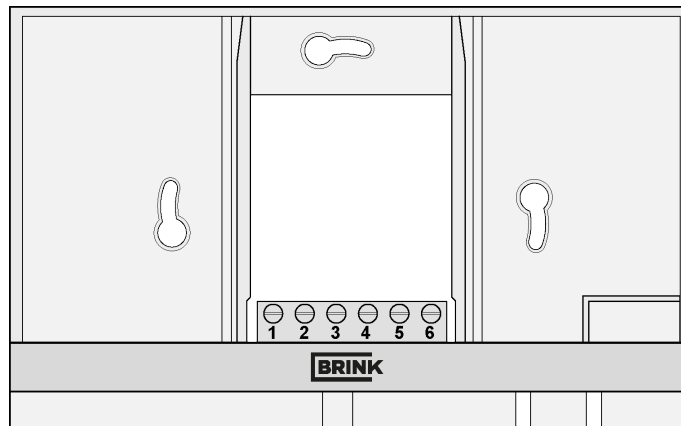

11.7 Image replacing operational module

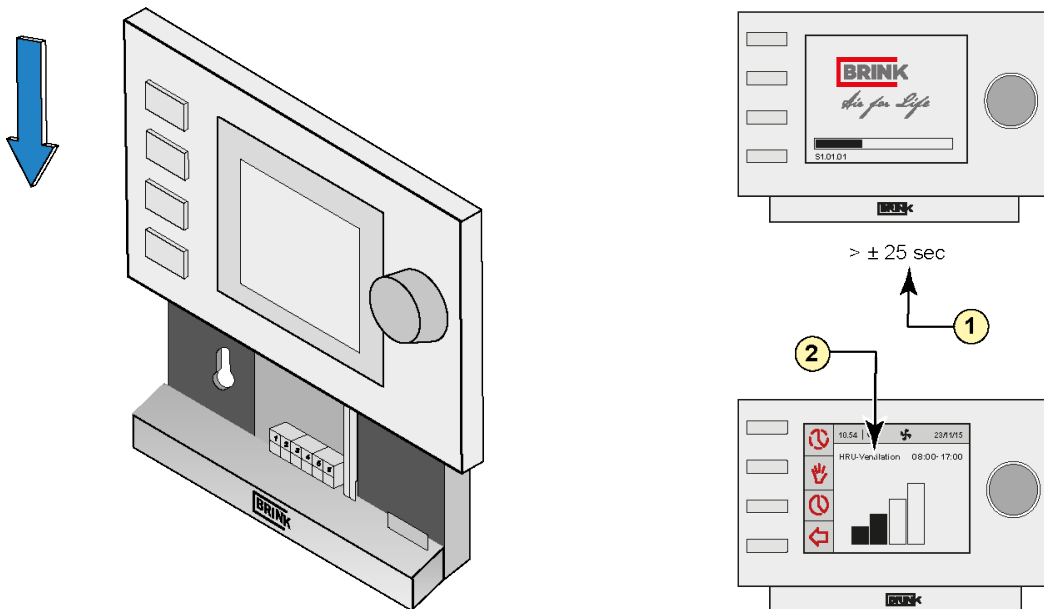

1 = ± 25 seconds

2 = HRU ventilation

11.8 Image filter notification

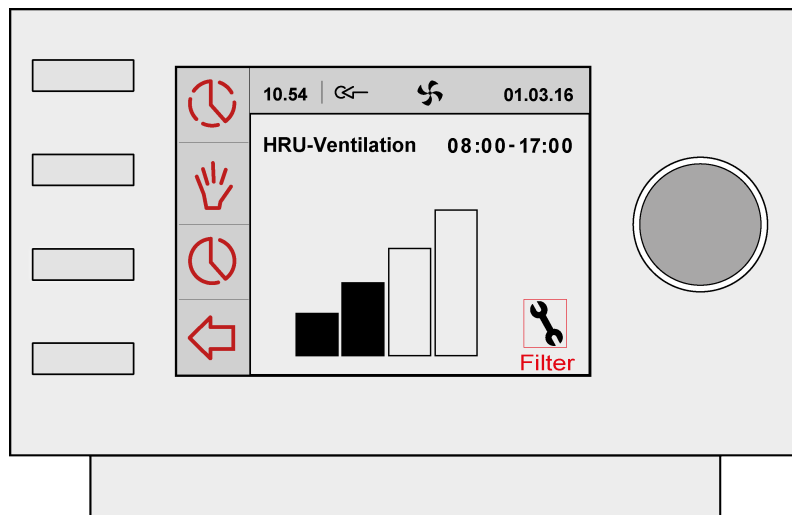

11.9 Image main menu display

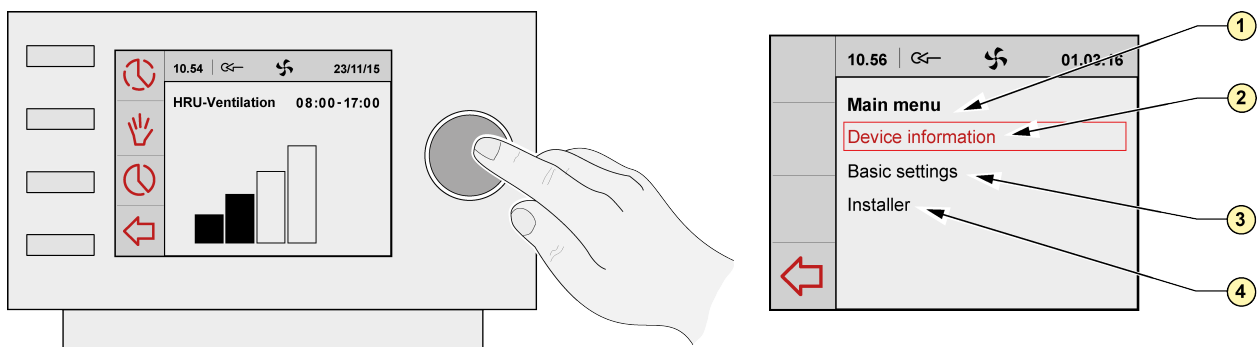

- 1 = Main menu
- 2 = Device information
- 3 = Basic settings
- 4 = Installer

11.10 Image resetting filter

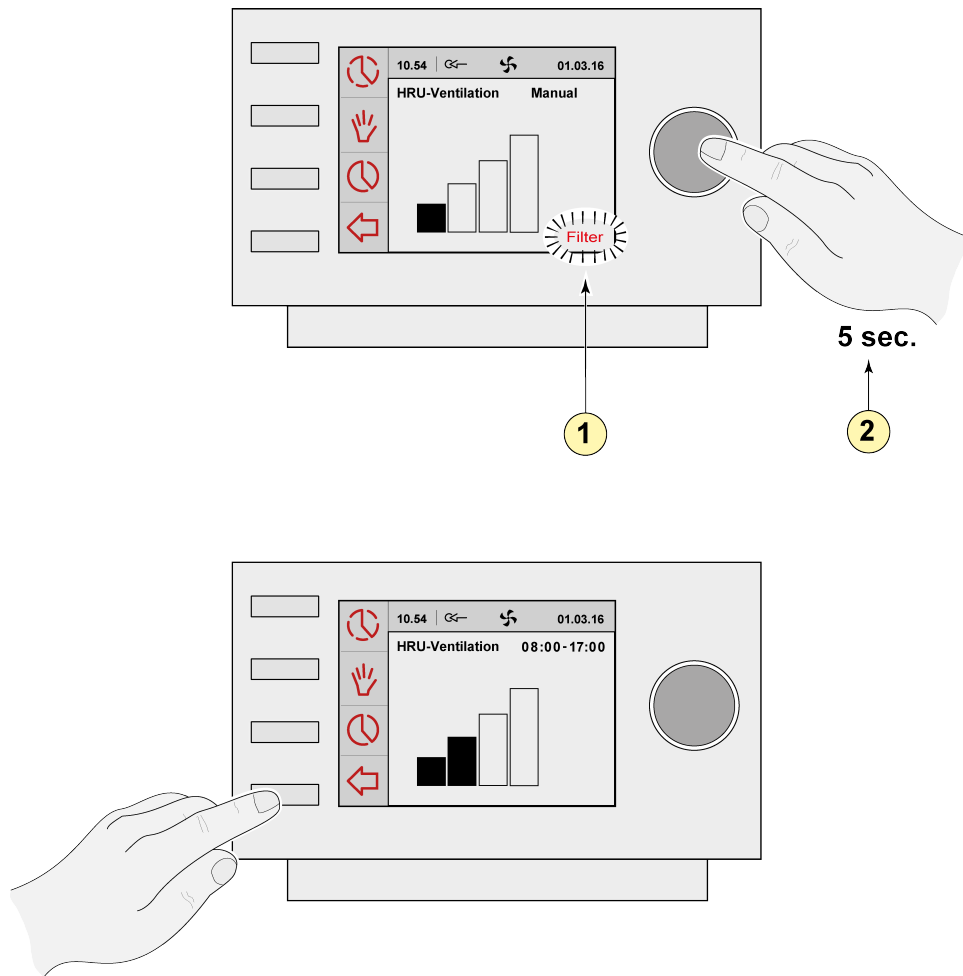

1 = Filter notification

2 = 5 seconds

11.11 Image device information menu

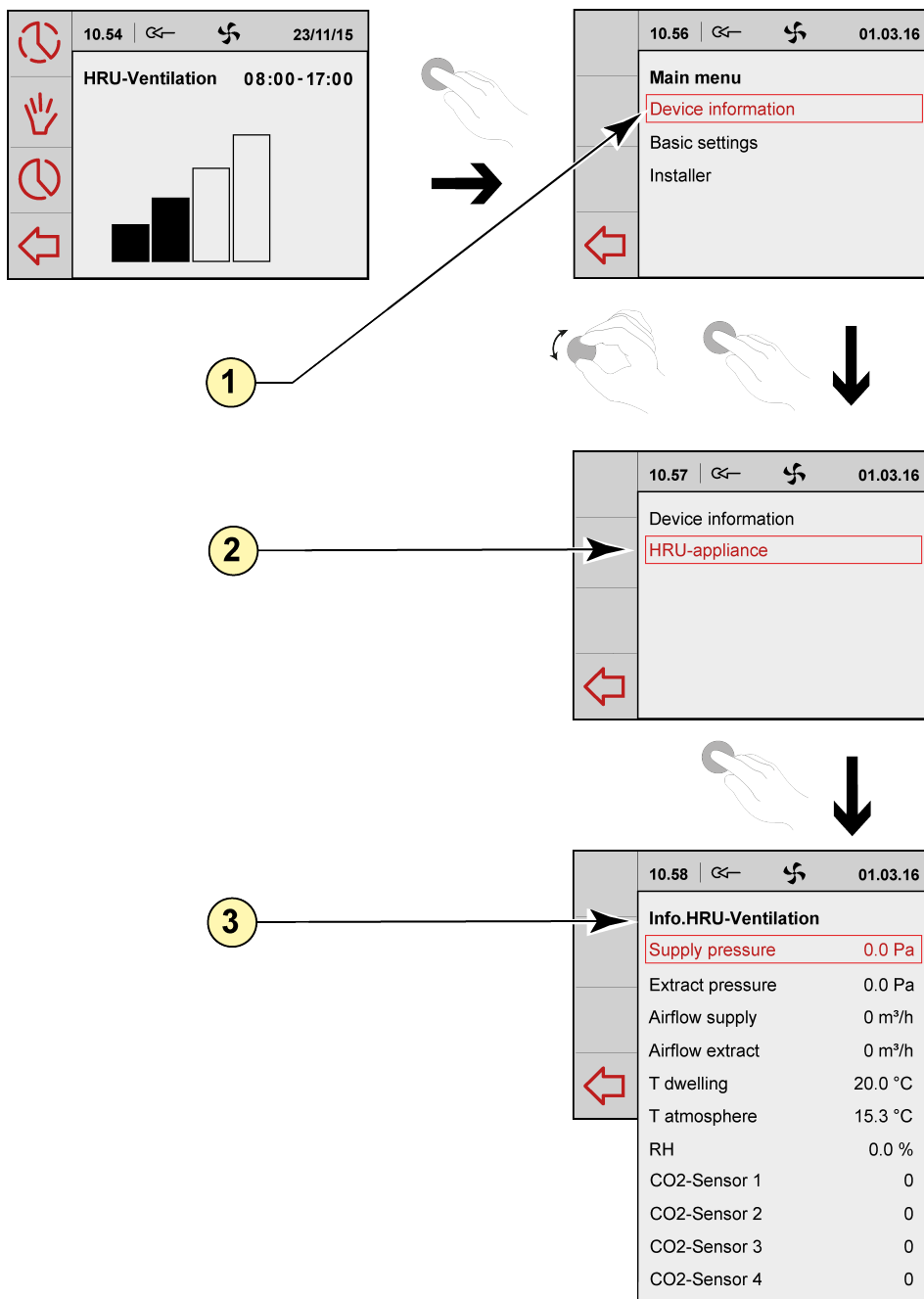

- 1 = Device information
- 2 = HRU-appliance
- 3 = Information HRU ventilation

11.12 Image basic settings

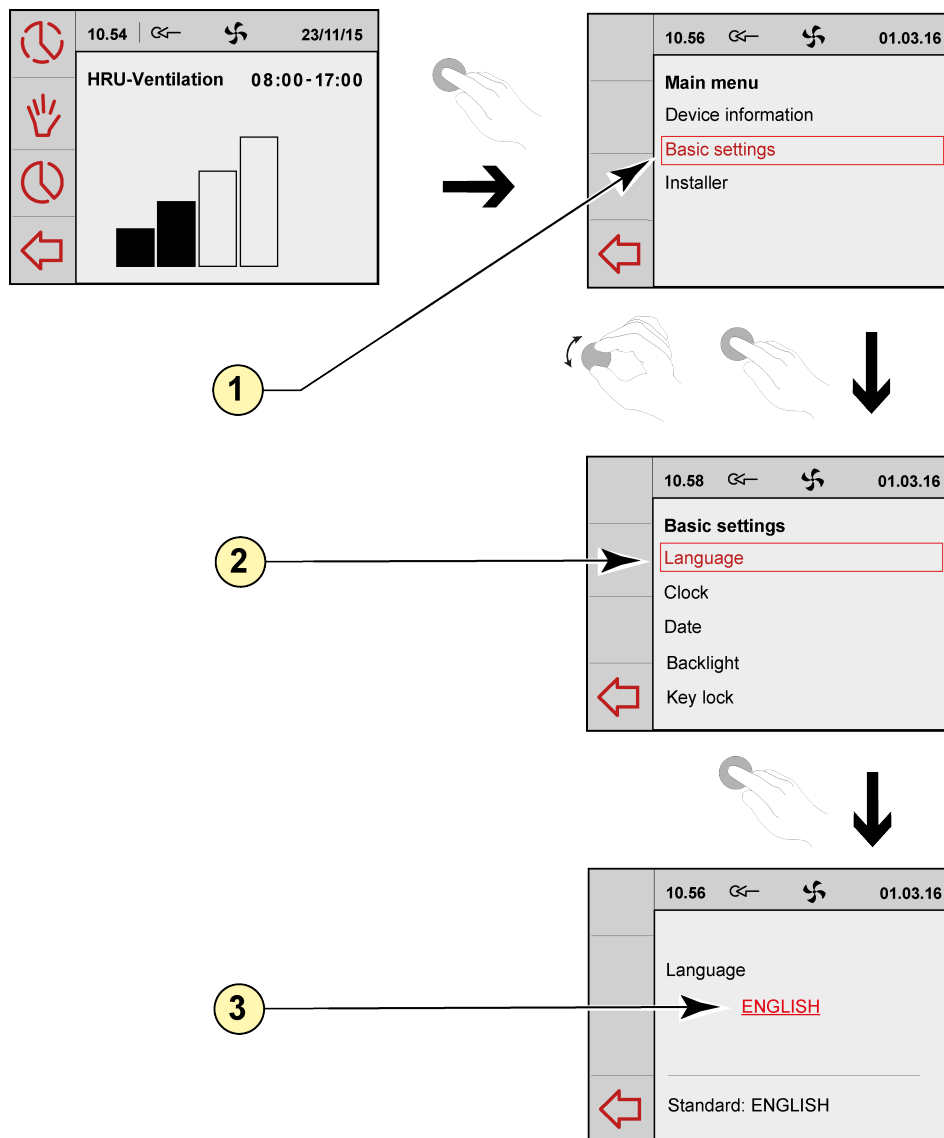

- 1 = Basic settings
- 2 = Language
- 3 = English

11.13 Image installer menu

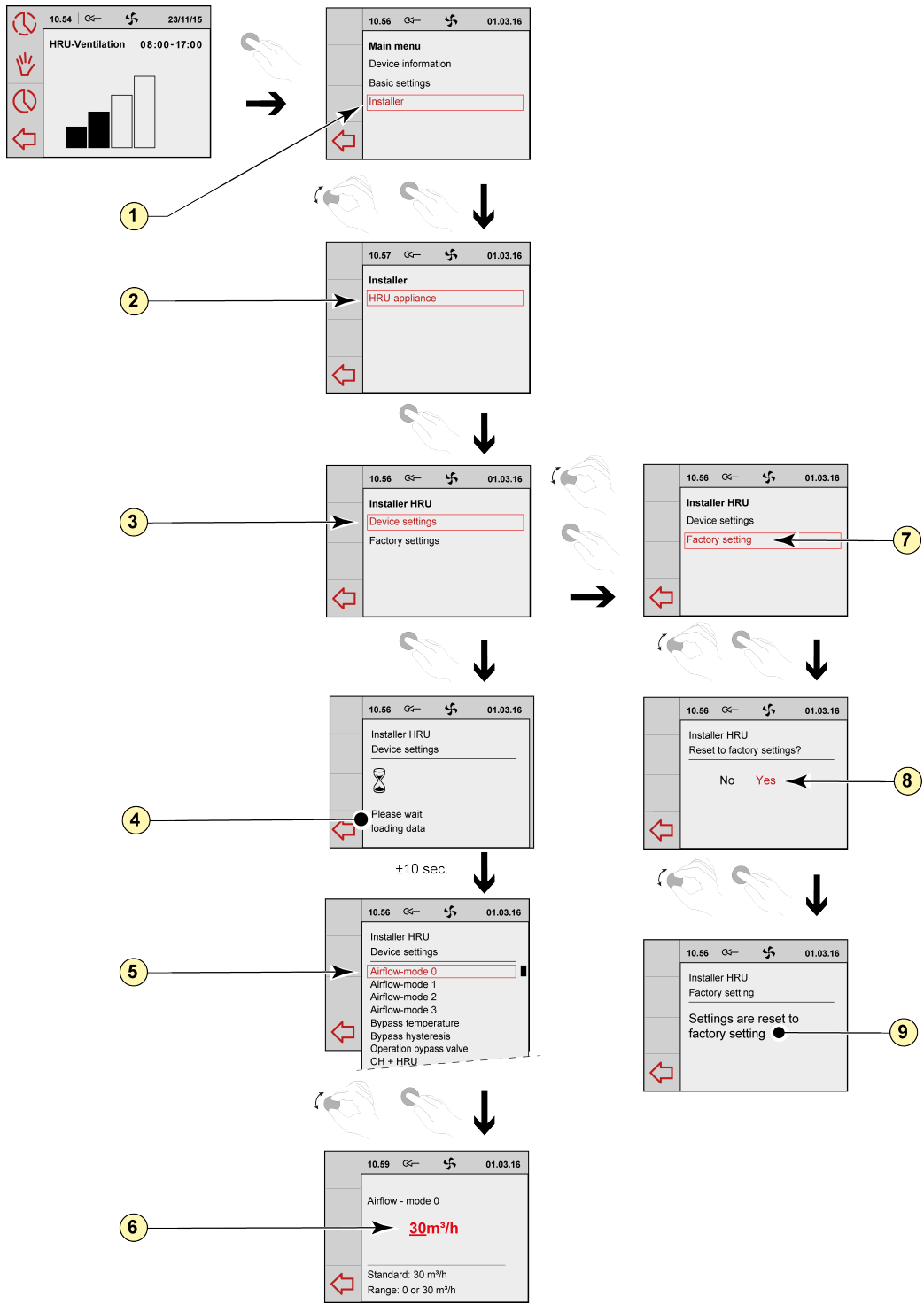

- | | |
|-------------------------------|---|
| 1 = Installer | 6 = Airflow 30 m ³ /h |
| 2 = HRU-appliance | 7 = Factory setting |
| 3 = Device settings | 8 = Yes |
| 4 = Please wait: Loading data | 9 = Settings are reset to factory setting |
| 5 = Airflow-mode 1 | |



Brink Climate Systems BV
P.O. Box 11 NL-7950AA Staphorst
T +31 (0) 522 46 99 44

E info@brinkclimatesystems.com
www.brinkclimatesystems.com
www.brinkairforlife.com